



EB-Certalume for PLT/C lamps

EB-C 218 PL-T/C 220-240V 50/60Hz

Affordable, reliable, high frequency electronic ballast for 4-pin PL-T and PL-C fluorescent lamps, ideal alternative for electromagnetic (EM) ballasts

Product data

General Information	
Type version	mk1
Lamp type	PL-T/C
Number of lamps	2 piece/unit
Number of products on MCB (16 A type B) (nom.)	20
Automatic restart	No

Operating and Electrical	
Input voltage	220 to 240 V
Input frequency	50 to 60 Hz
Operating frequency (nom.)	42-60 kHz
Crest factor (nom.)	1.9
Power factor 100% load (nom.)	0.95
Mains voltage safety (AC)	-10% - +10%
Earth leakage current (nom.)	0.7 mA

Wiring	
Connector type input terminals	250 manual connector [Suitable for manual wiring and easy release button]
Cable capacity output wires mutual (max.)	120 pF
Colour input terminals	Orange

Colour output terminals	Grey
Connector type output terminals	250 manual connector [Suitable for manual wiring and easy release button]
Cable length hot-wiring	0.75 m
Wire strip length	9.0-10.0 mm
Dual fixture master/slave	Not advisable [Master/Slave operation not advised]
Input terminal cross section	0.50-1.50 mm ²
Output terminal cross section	0.50-1.50 mm ²
Cable capacity output wires to earth (max.)	120 pF

System characteristics	
Rated ballast-lamp power	18 W
System power on PL-T/C	38.0 W
Power loss on PL-T/C	5.0 W
Lamp power on PL-T/C	16.5 W

Temperature	
T case lifetime (nom.)	65 °C
T-Case maximum (max.)	65 °C

EB-Certalume for PLT/C lamps

Mechanical and Housing	
Housing	- [Not Specified]
Emergency Operation	
Battery voltage lamp ignition	165-253 V
Approval and Application	
Energy efficiency index	A2
IP classification	IP 20 [Ingress Protection 20]
Overvoltage protection 276 VAC	48 h
EMI 9 kHz... 30 MHz	EN55015
Vibration standard	IEC68-2-6 F c
Bumps standard	IEC 68-2-29 Eb
Humidity standard	EN61347-I

Approval marks	CCC certificate CB Certificate
Product Data	
Full product code	872790083289100
Order product name	EB-C 218 PL-T/C 220-240V 50/60Hz
EAN/UPC – product	8711500997753
Order code	83289100
Numerator – quantity per pack	1
Numerator – packs per outer box	24
Material no. (12NC)	913713198714
Net weight (piece)	0.132 kg

Dimensional drawing

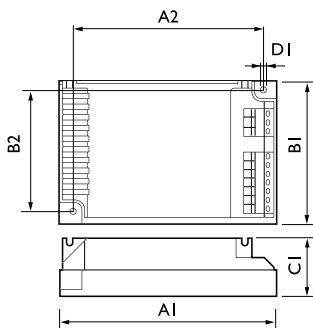

EB-C 218 PL-T/C 220-240V 50/60Hz

Product	D1	C1	A1	A2	B1
EB-C 218 PL-T/C 220-240V 50/60Hz	4.2 mm	31.0 mm	94.0 mm	86.0 mm	72.0 mm

